

THE BRIDGE EXP
3 INTRODUCTION
ARCH1101 LOWE

THE CLIENTS
THE BRIEF

THE BRIDGE

THE BRIDGE EXP
3 INTRODUCTION
ARCH1101 HARK
INS

THE CLIENTS
THE BRIEF

THE BRIDGE

THE CLIENTS

Coca-Cola®



open happiness™





Facebook Use by Age Group

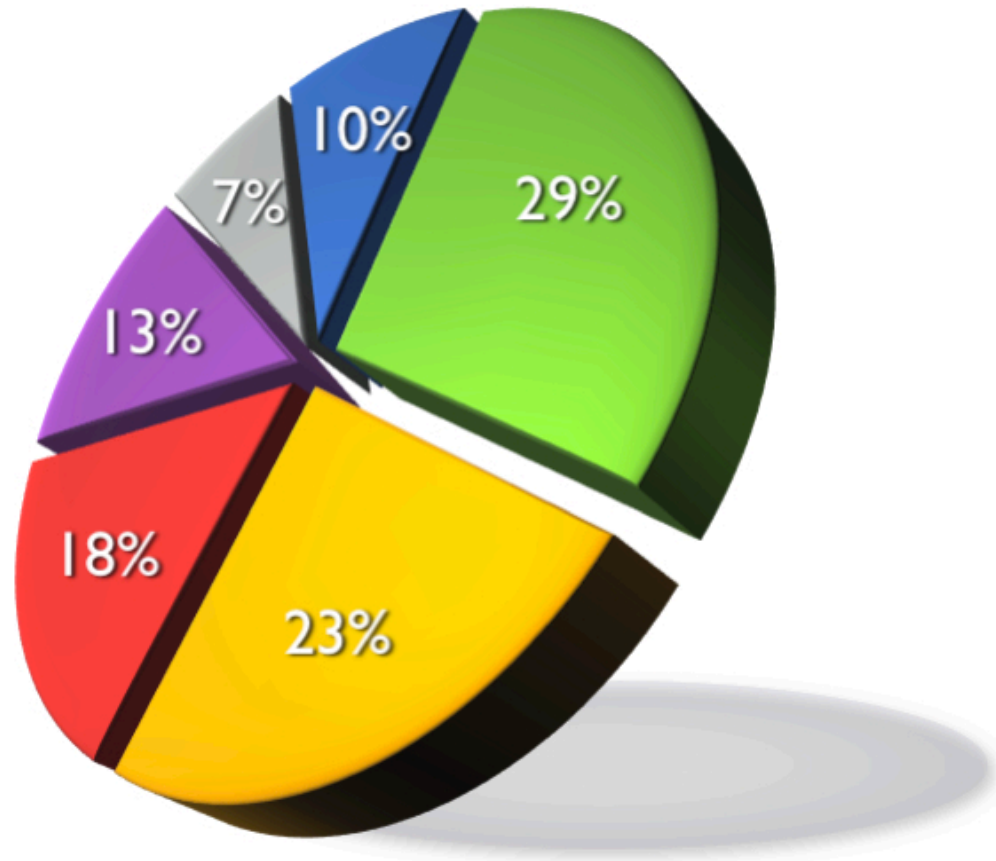

● 13 to 17 ● 18 to 25 ● 26 to 34 ● 35 to 44 ● 45 to 54 ● 55 to 65

Source: *Branded!* and InsideFacebook.com



TM

**T A K E T W O
I N T E R A C T I V E**

grand
tneft
auto



EXUS.gaming



Connect the bomb to the battery and starter motor.





MAX PAYNE 3





RED DEAD REDEMPTION™







Brothers*ft

THE BRIEF

THE BRIDGE

ENGINEERING

**ENGINEERING
ARCHITECTURE**

**ENGINEERING
ARCHITECTURE
SCIENCE**

ENGINEERING
ARCHITECTURE
SCIENCE
ART

CONSTRUCTION

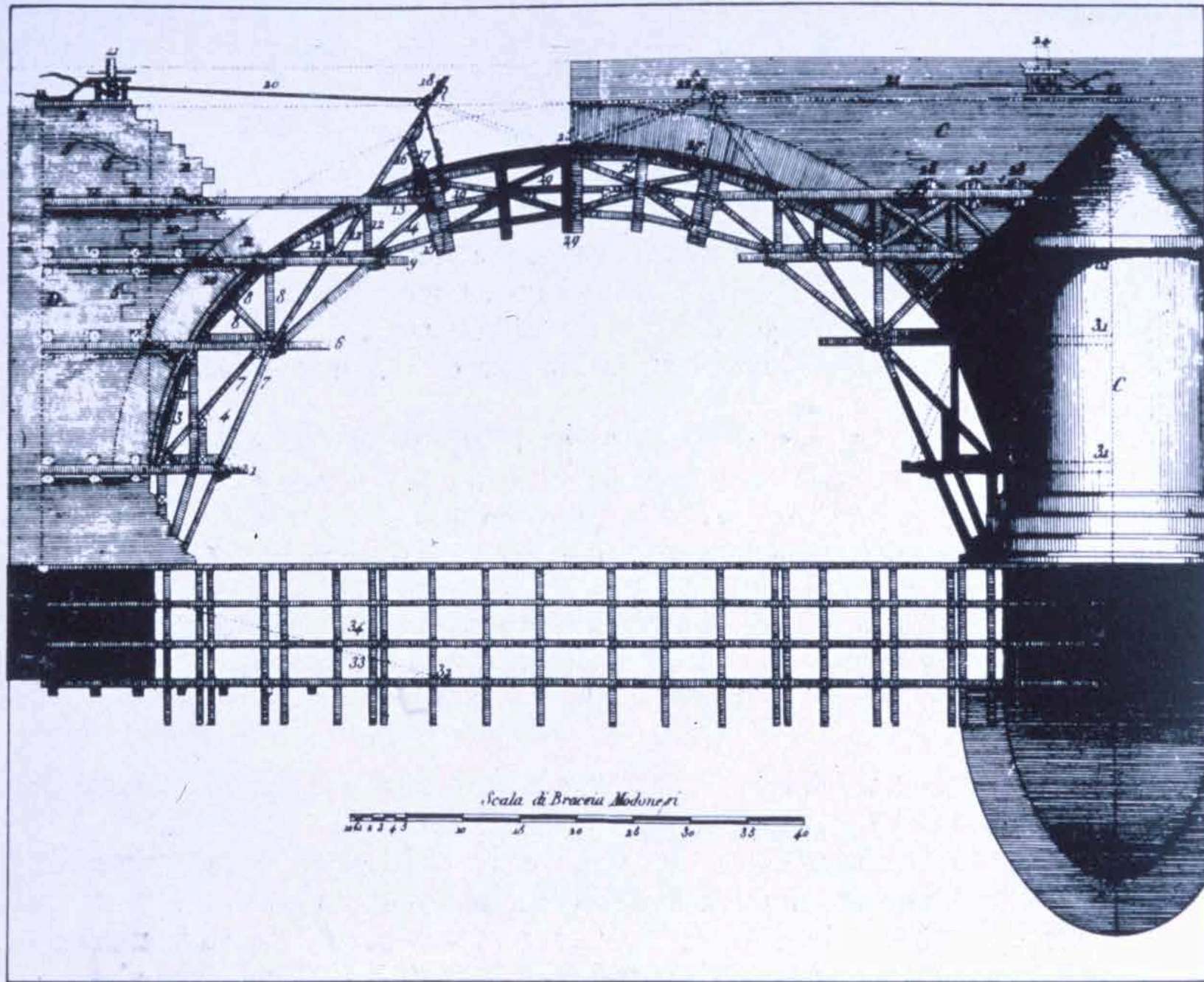

Scala di Braccia Modenesi

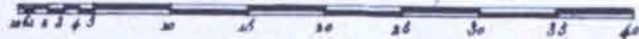

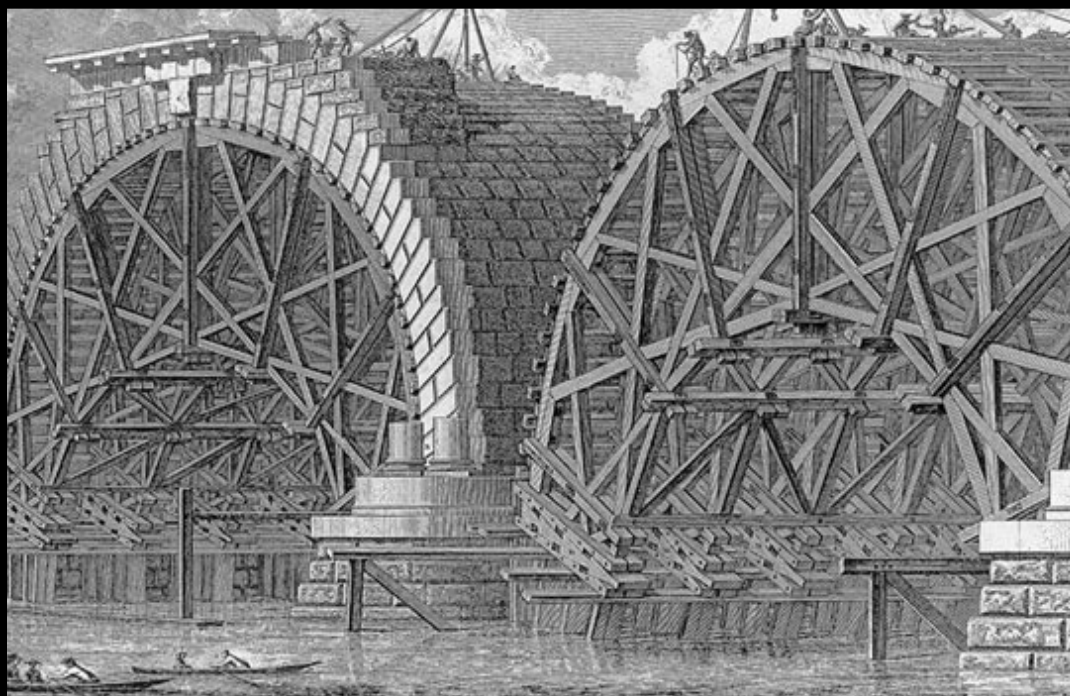

A · VIEW · OF · PART · OF · THE · INTENDED
IN · AVGVST
BY · ROBERT · MYLNE · ARCHITECT

BRIDGE · AT · BLACKFRIARS · LONDON
MDCCLXIII
ENGRAVED · BY · PIRANESI · AT · ROME

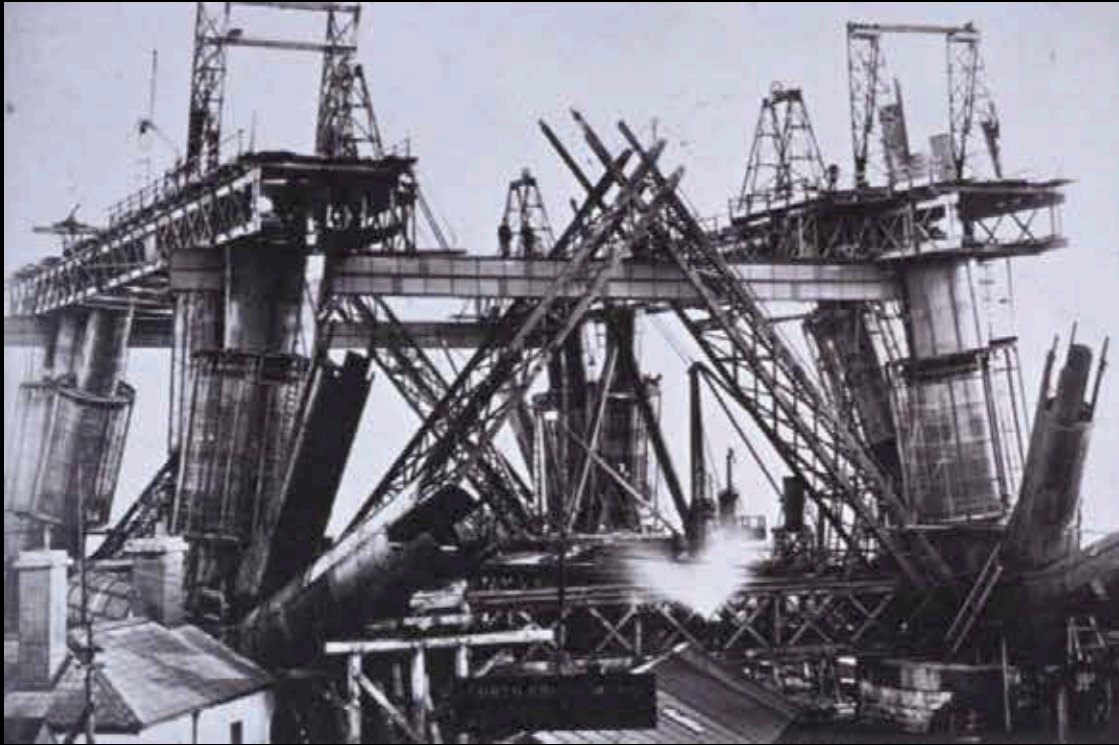













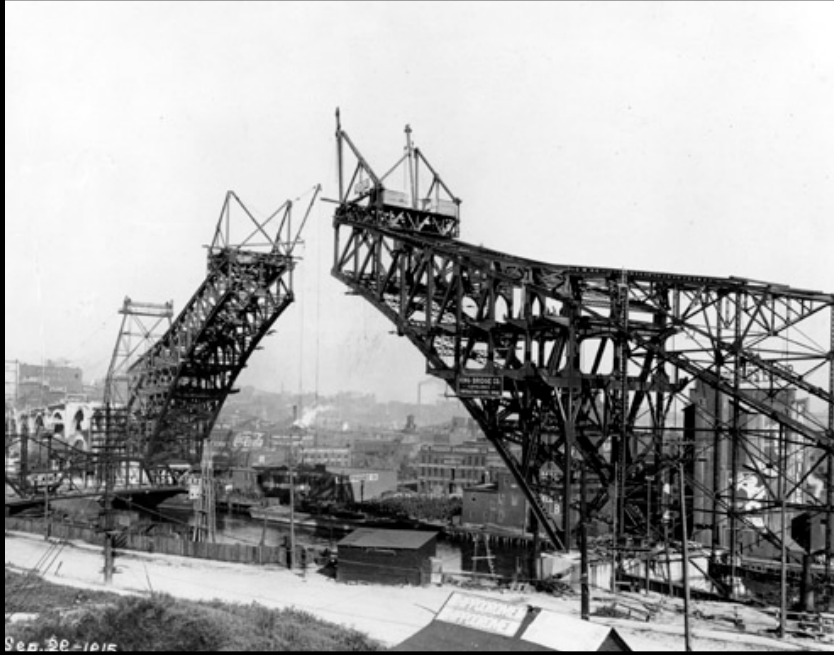

STRUCTURE

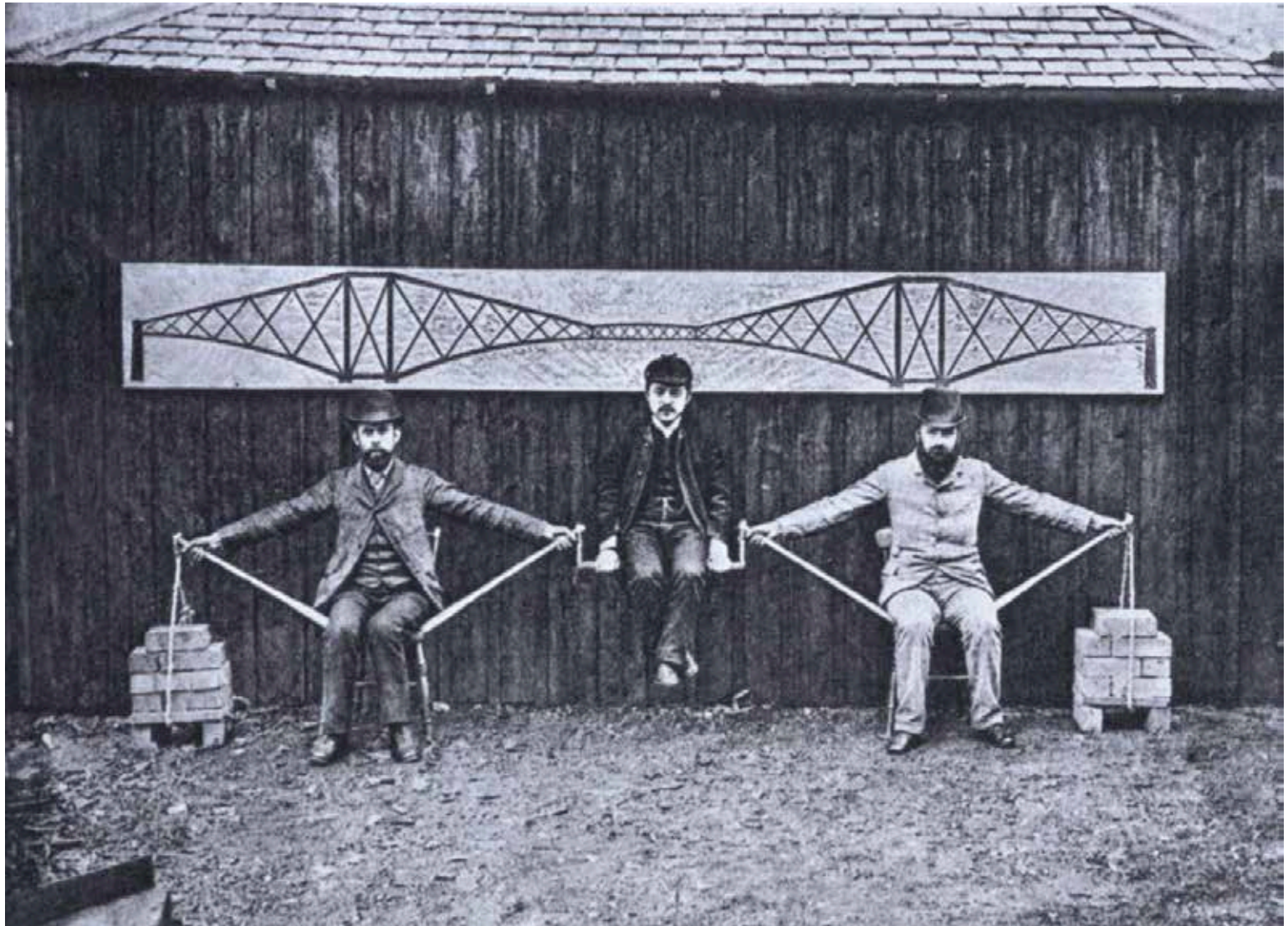

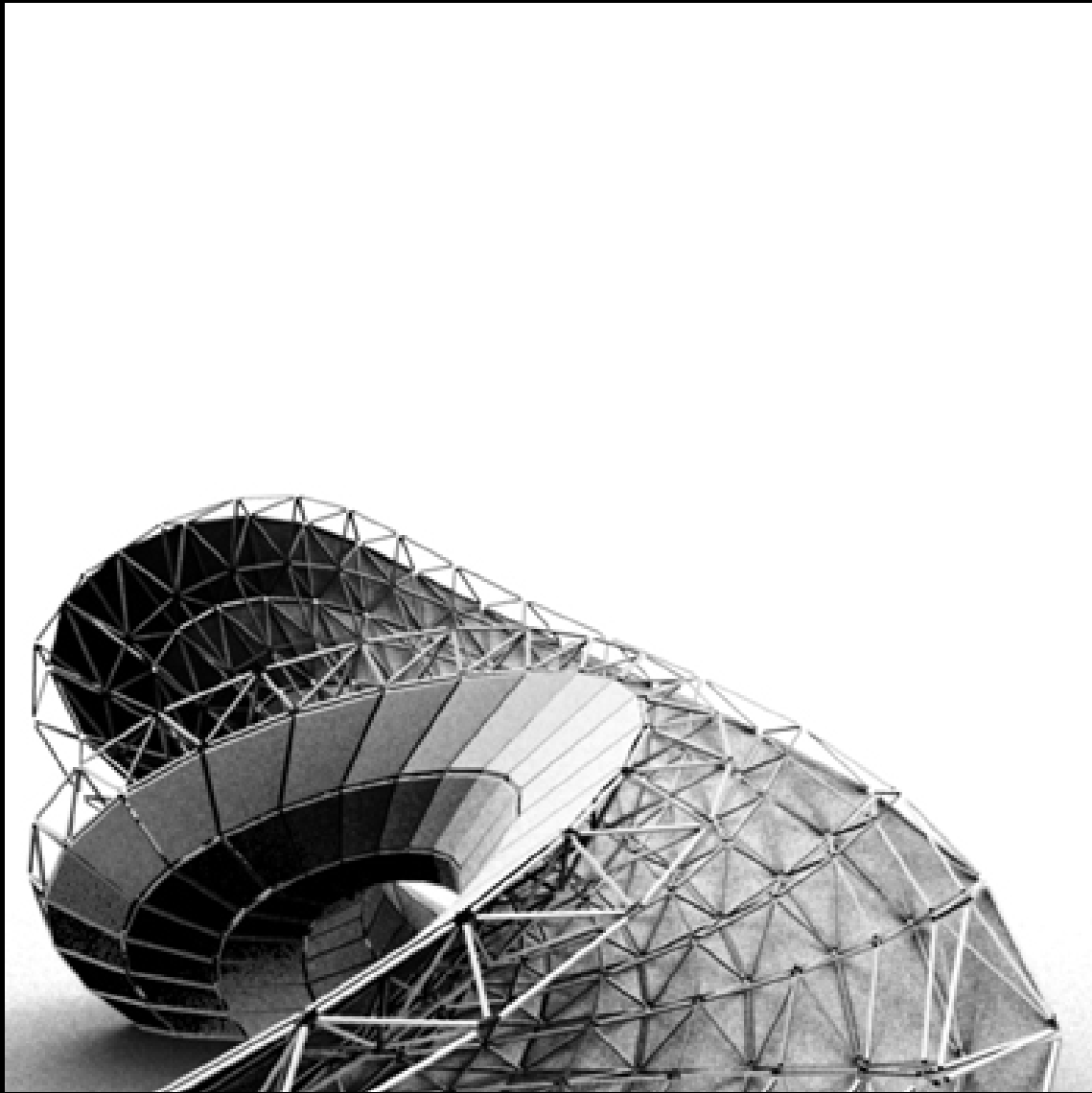

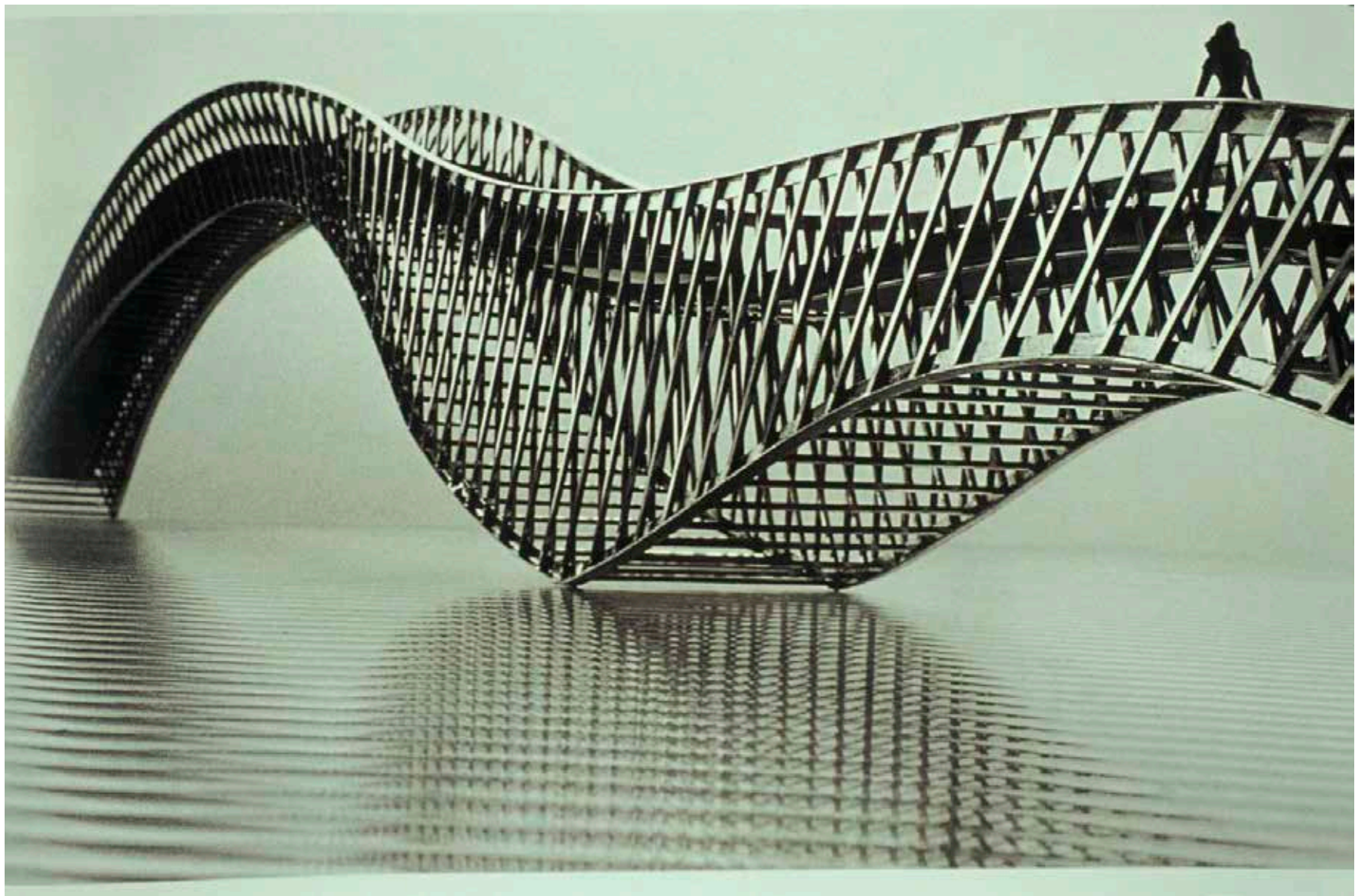



Equivalent Stress
x 1e3 psi
Max: 1.104e+003
Min: 1.576e+000
1/31/2007 6:10 PM

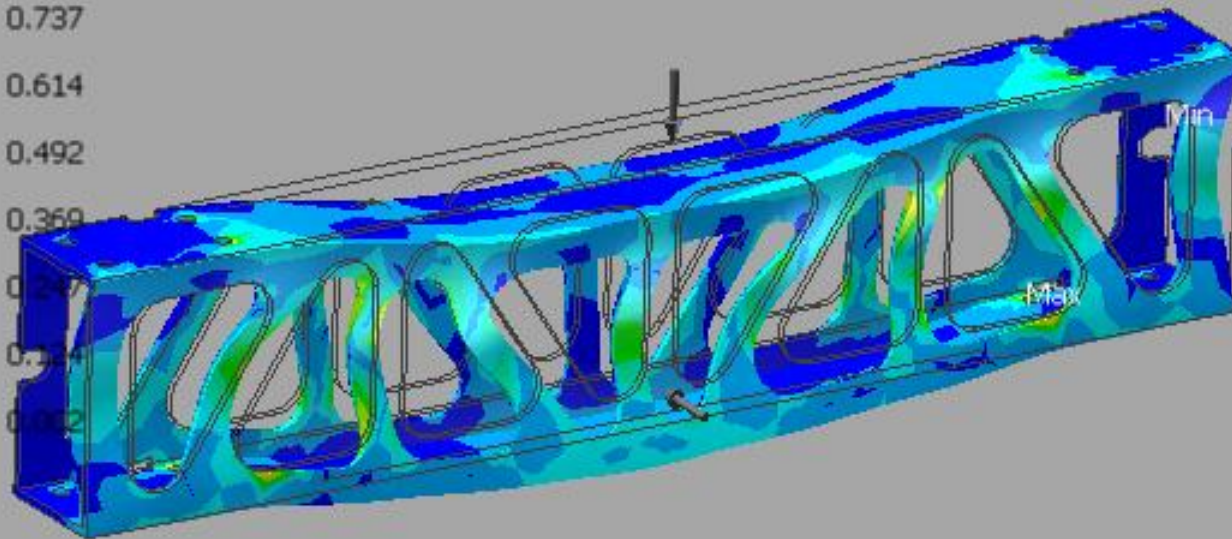
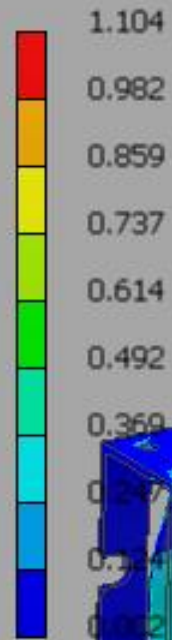

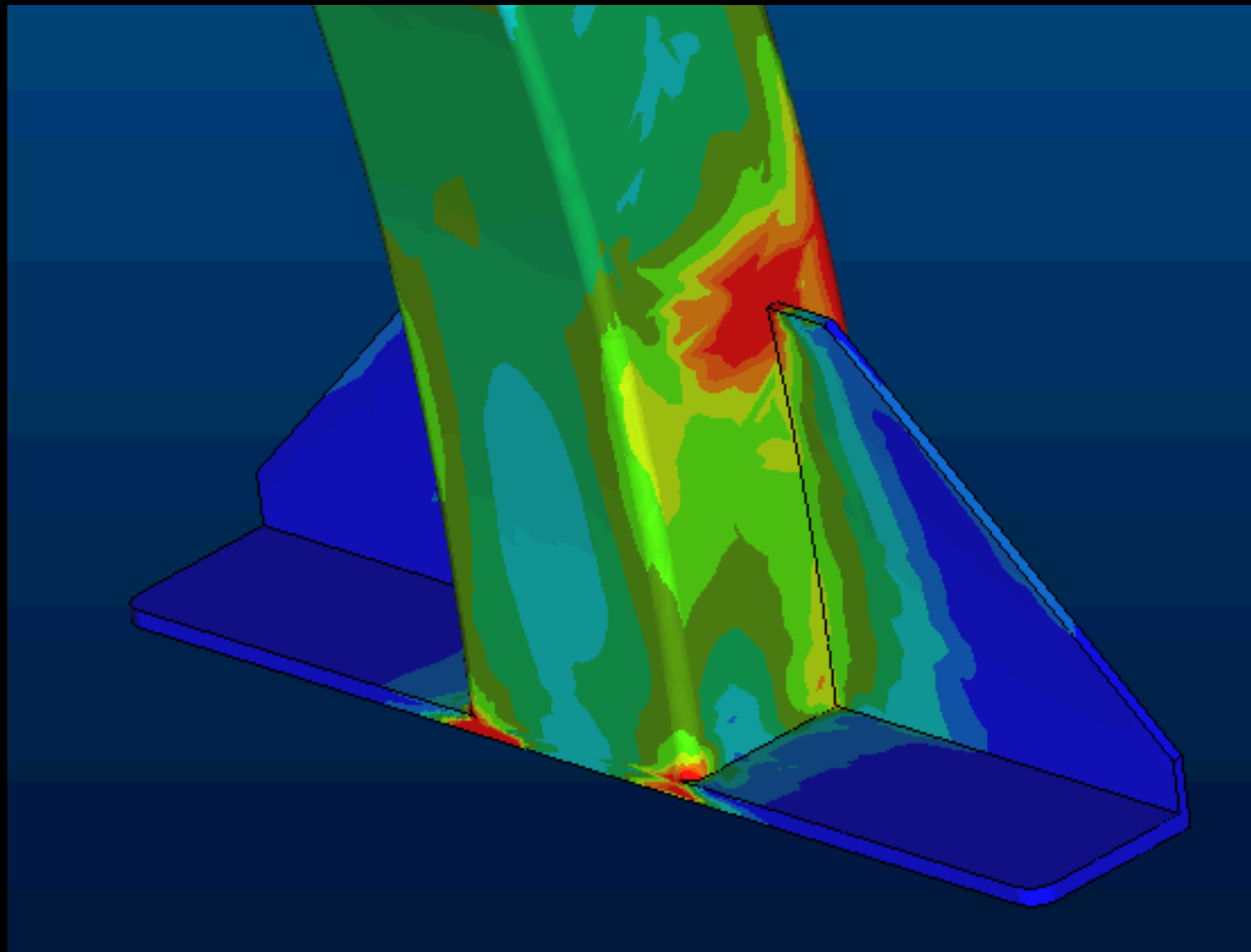

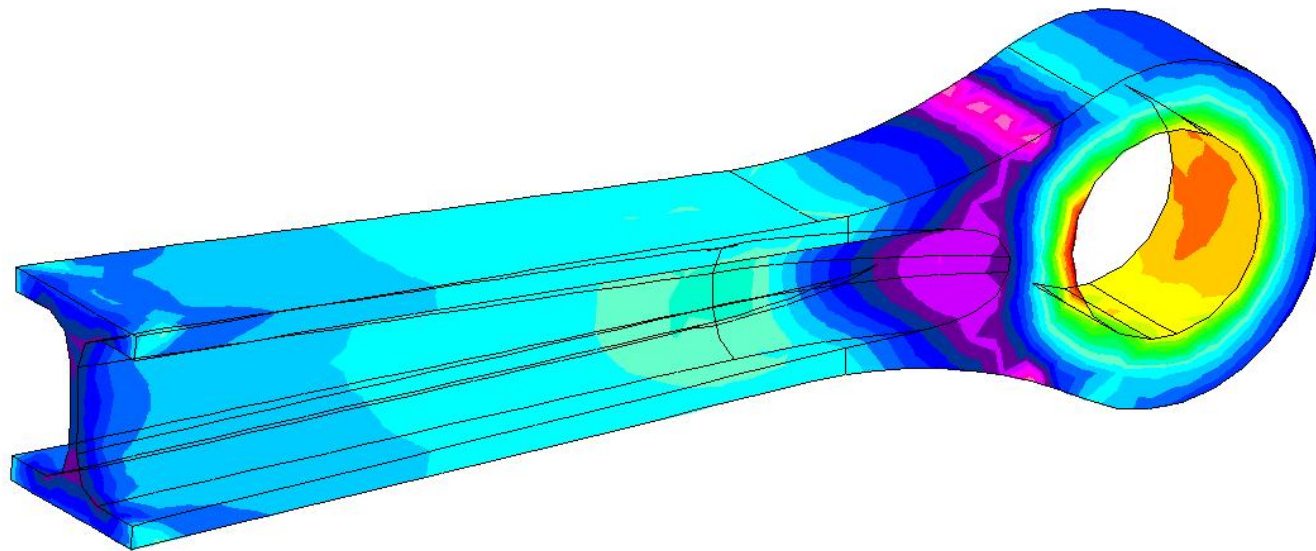

Material	
S235JR	
Yield Point 235.00	
Von Mises	
[N/mm ²]	
max	238.01965
	209.19926
	200.27927
	191.55918
	182.79909
	173.91899
	165.09890
	156.27881
	147.45872
	138.63863
	129.81854
	120.99845
	112.17835
	103.35826
	94.53817
	85.71808
	76.89799
	68.07790
	59.25781
	50.43771
	41.61762
	32.79753
	23.97744
	15.15735
min	6.33726

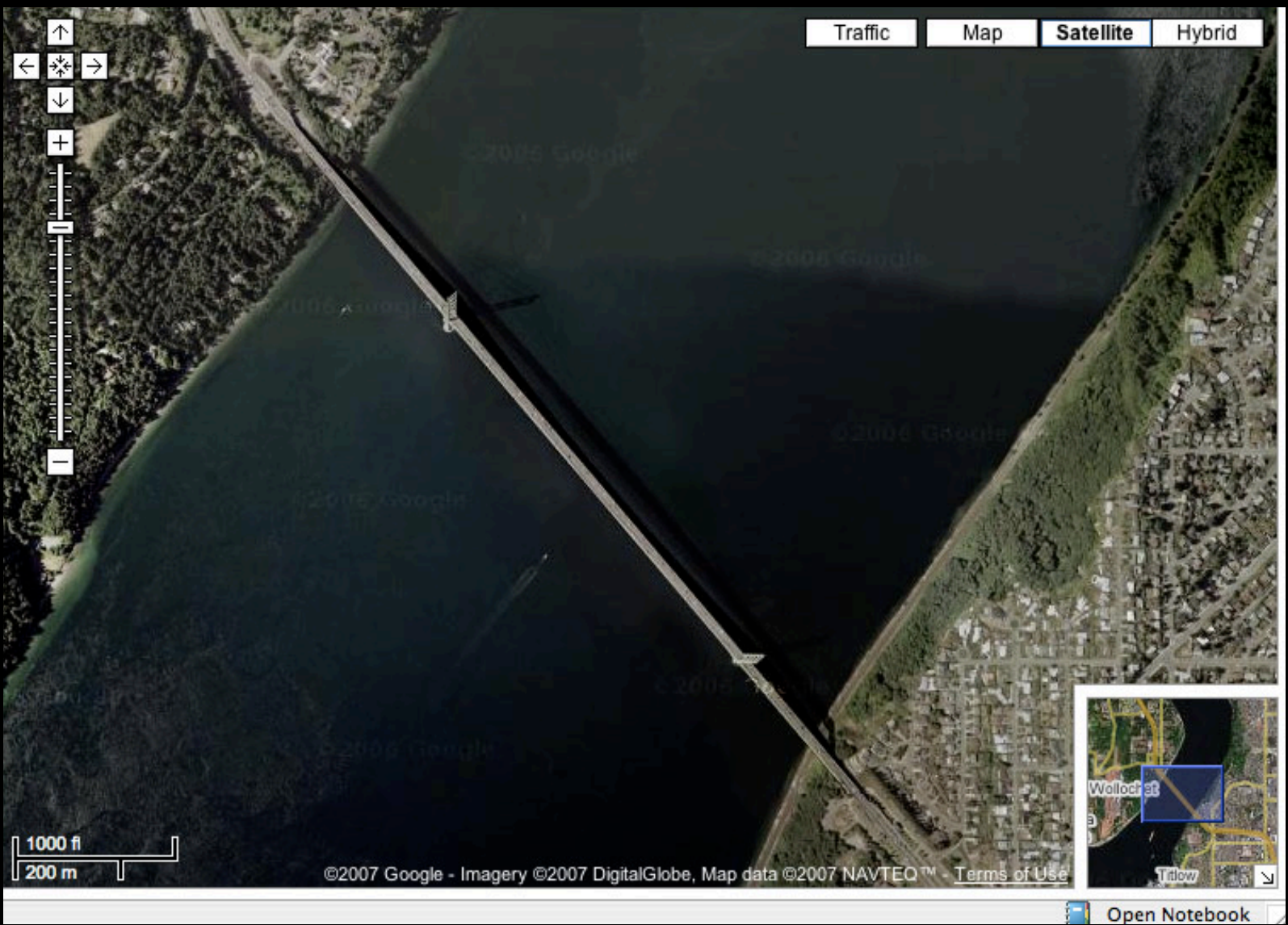

Traffic

Map

Satellite

Hybrid

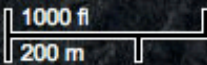

©2007 Google - Imagery ©2007 DigitalGlobe, Map data ©2007 NAVTEQ™ - Terms of Use



Open Notebook







**TACOMA NARROWS NEWSREEL
YOUTUBE**







CALATRAVA



~~CALATRAVA~~



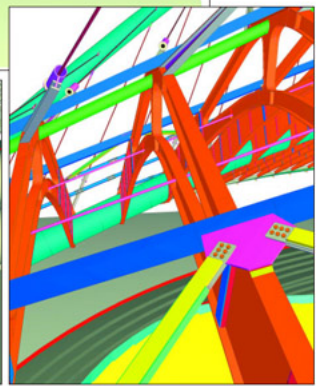
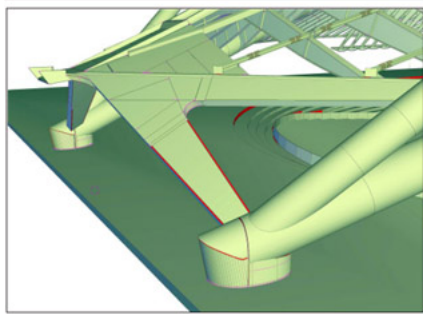
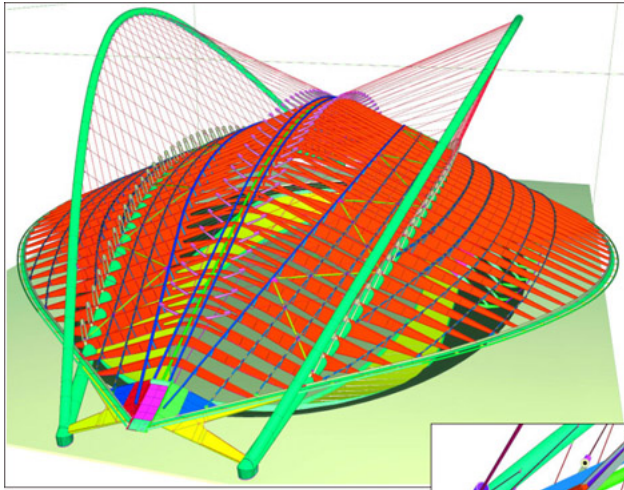

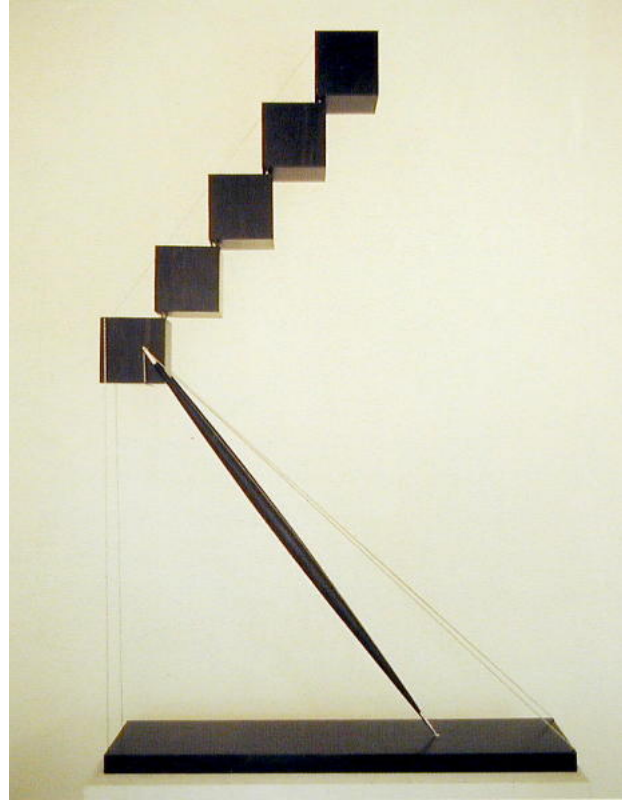
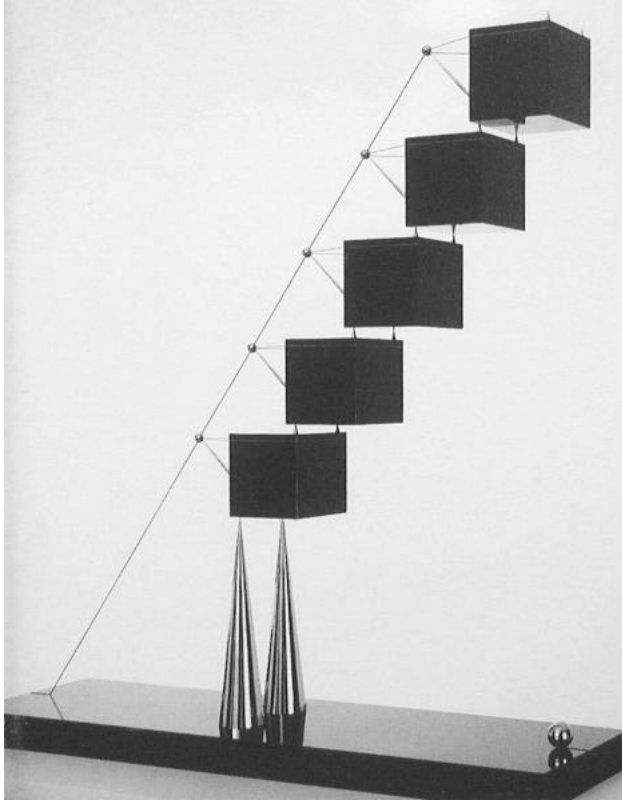

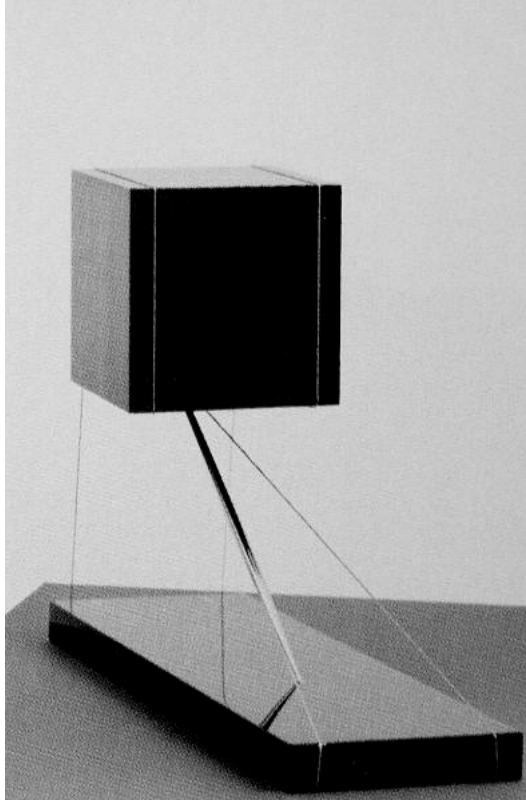

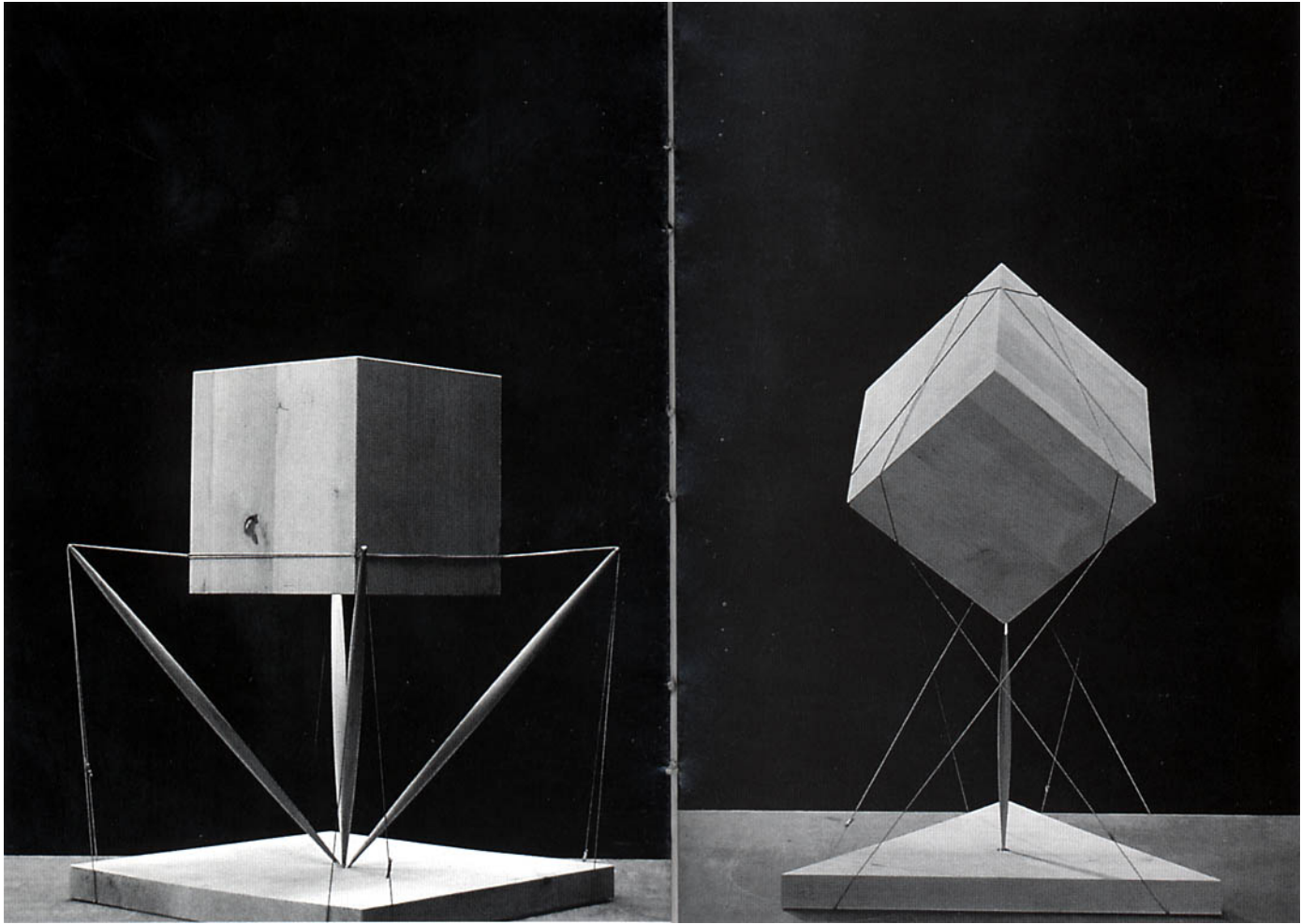

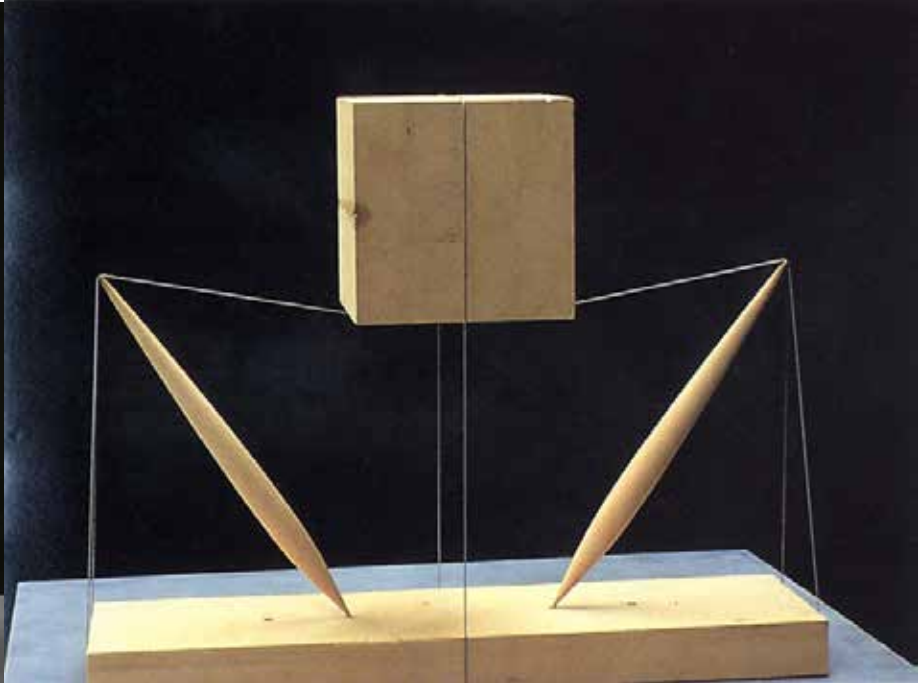

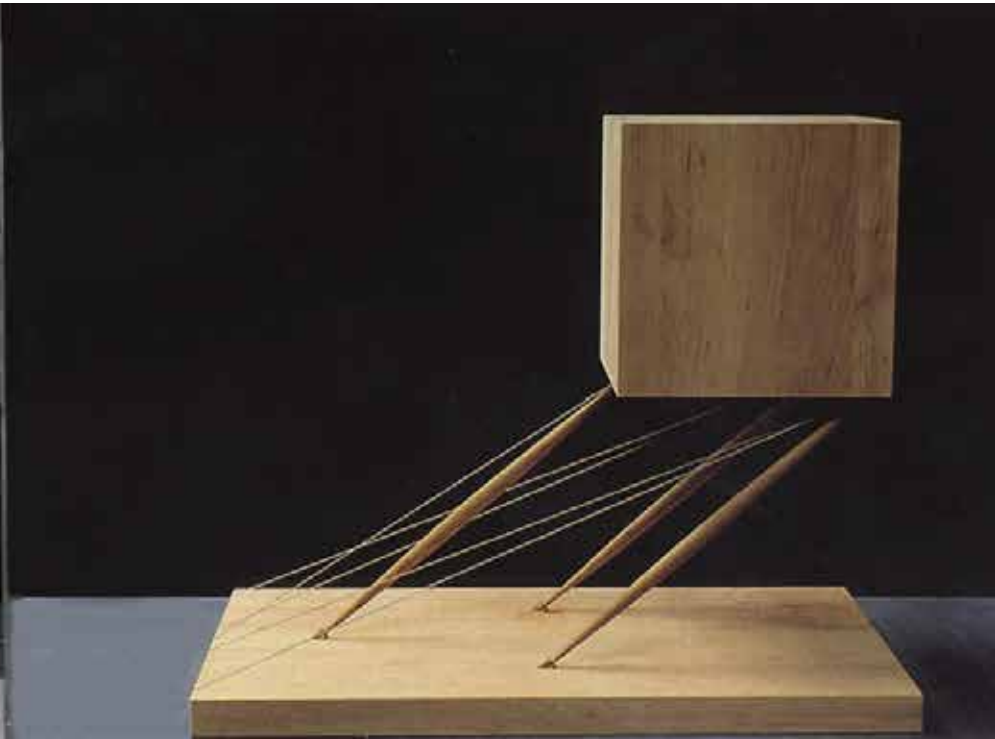
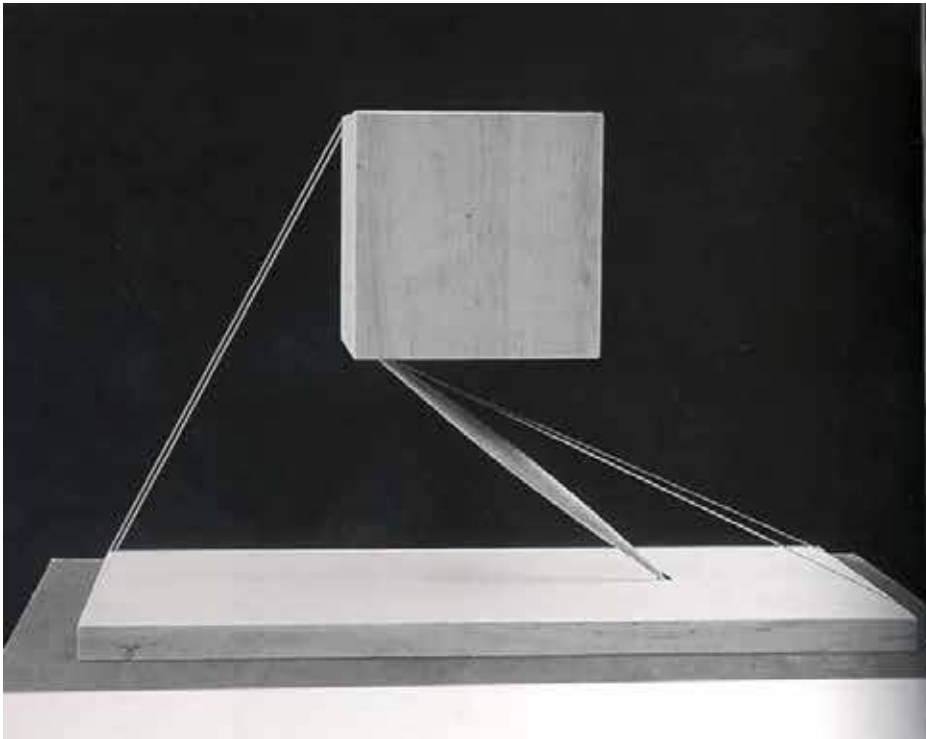

COVERED





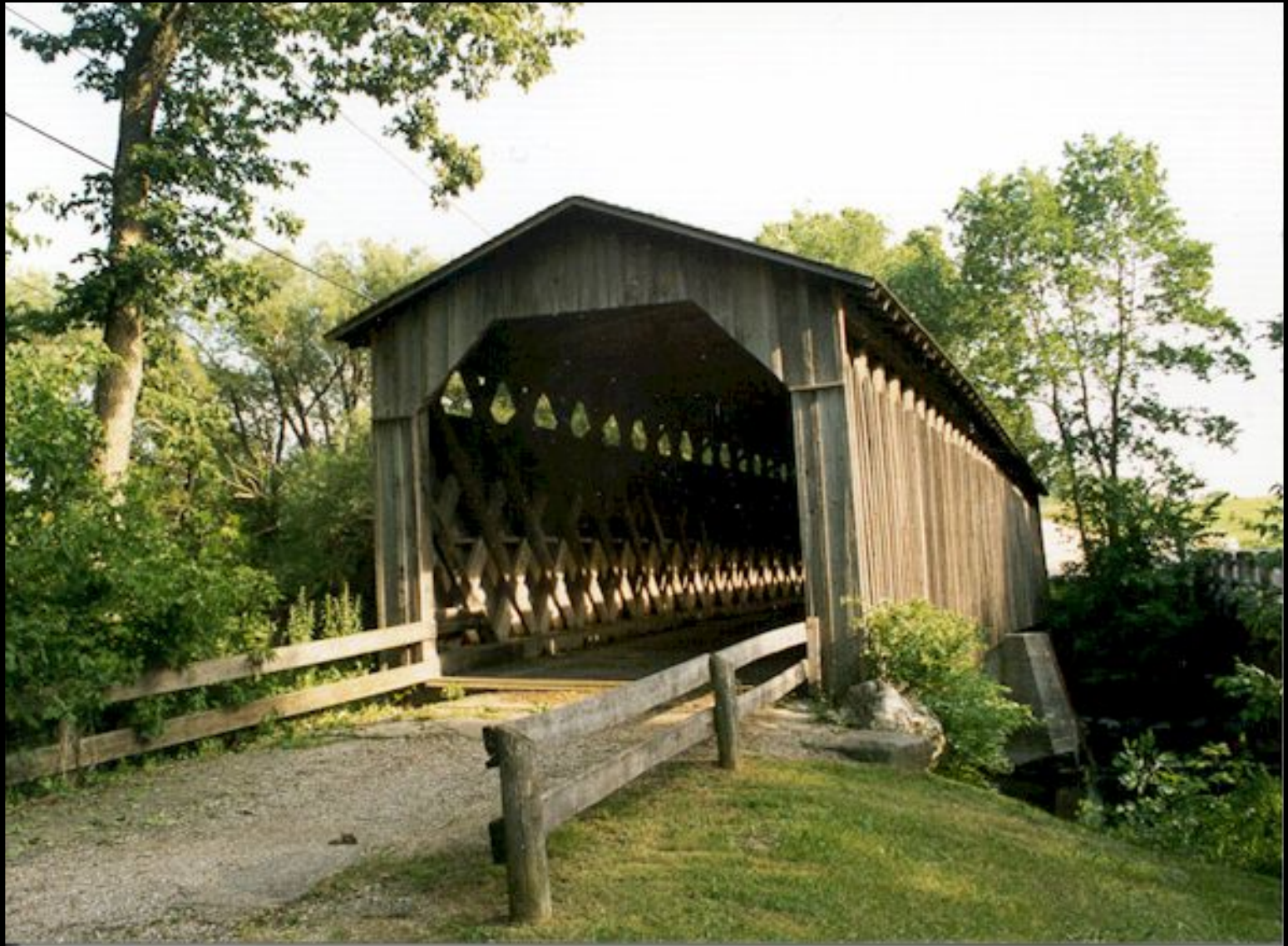





PALLADIO









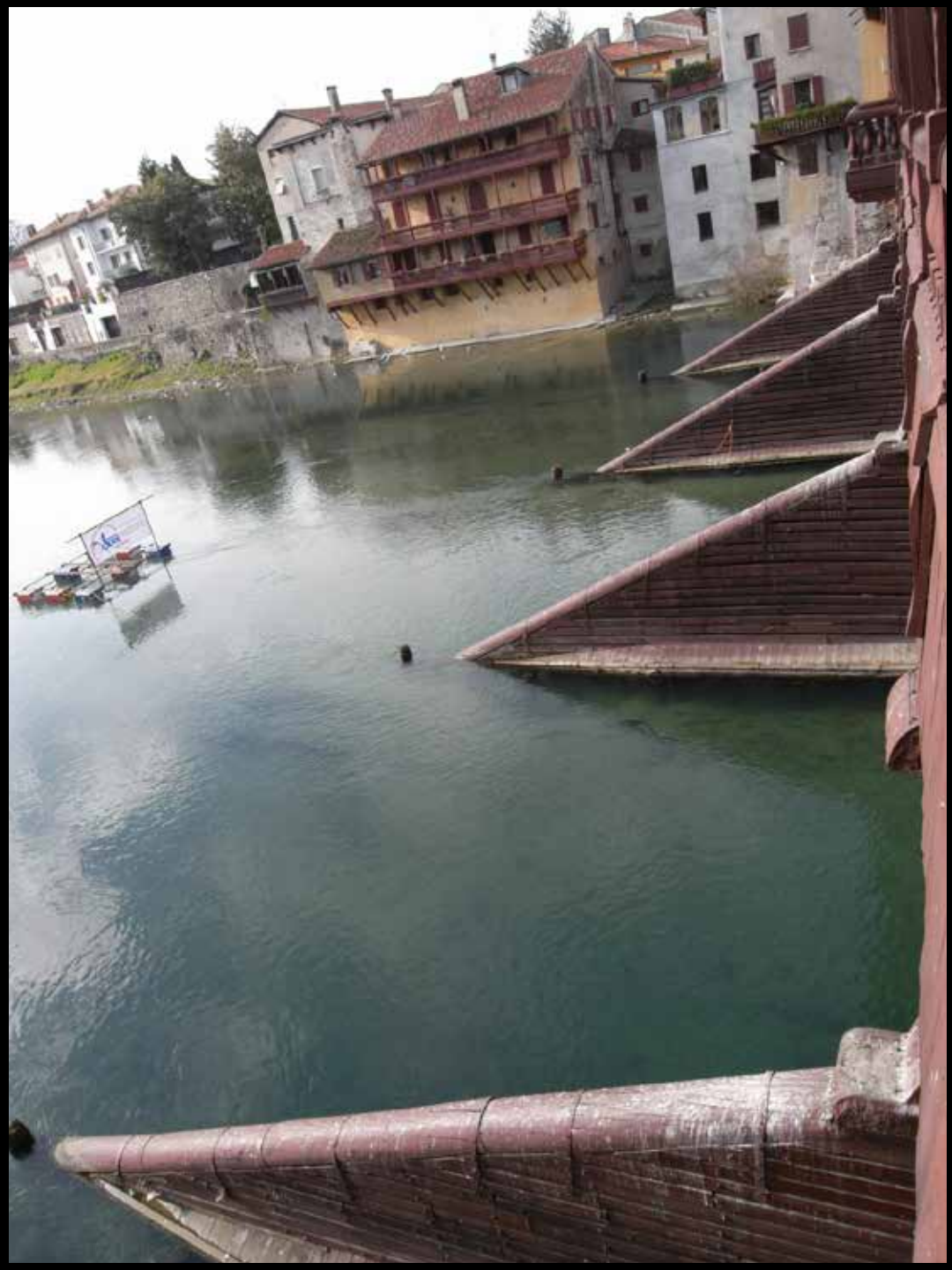

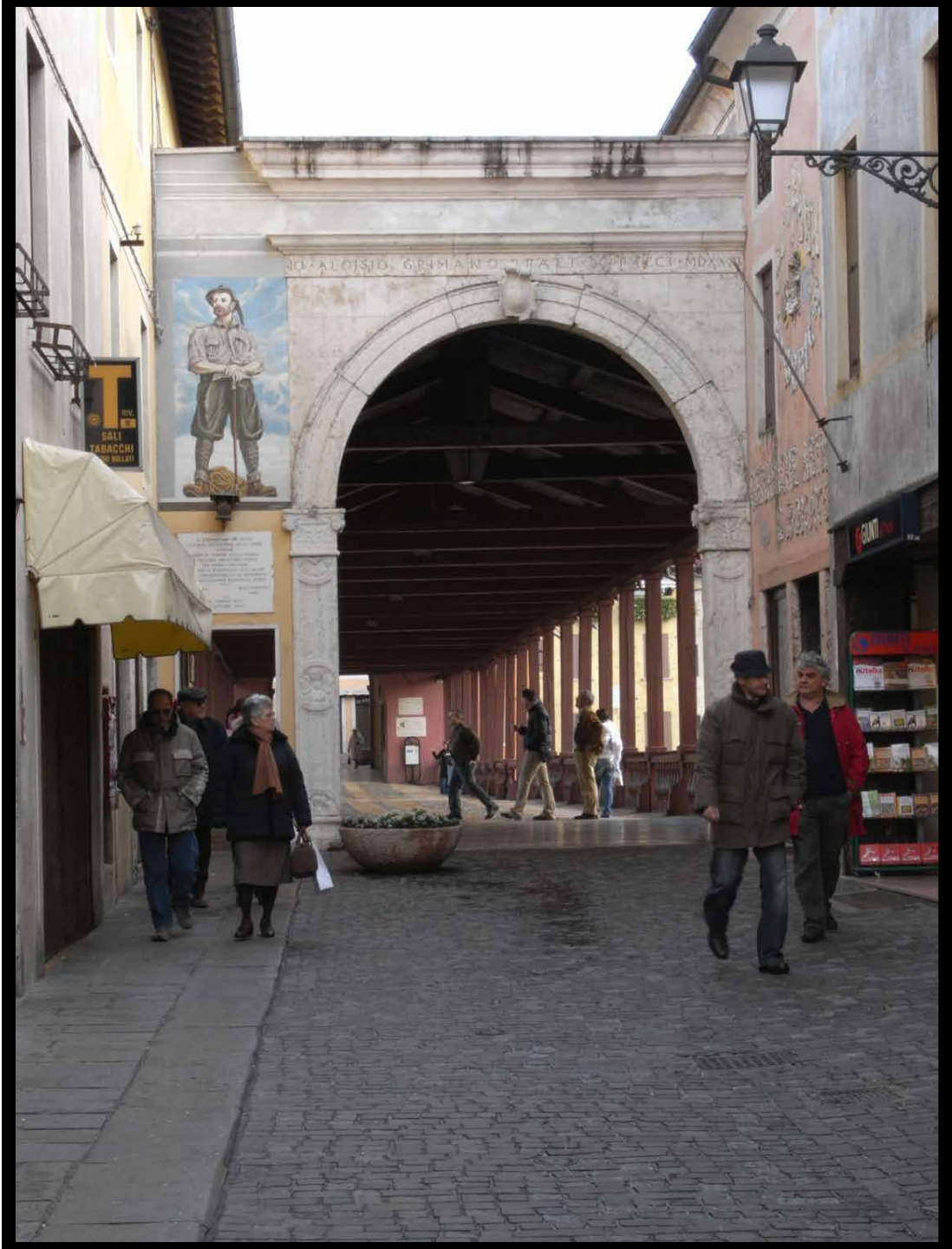







HOUSE















PONTE VECCHIO









HUGH FERRISS



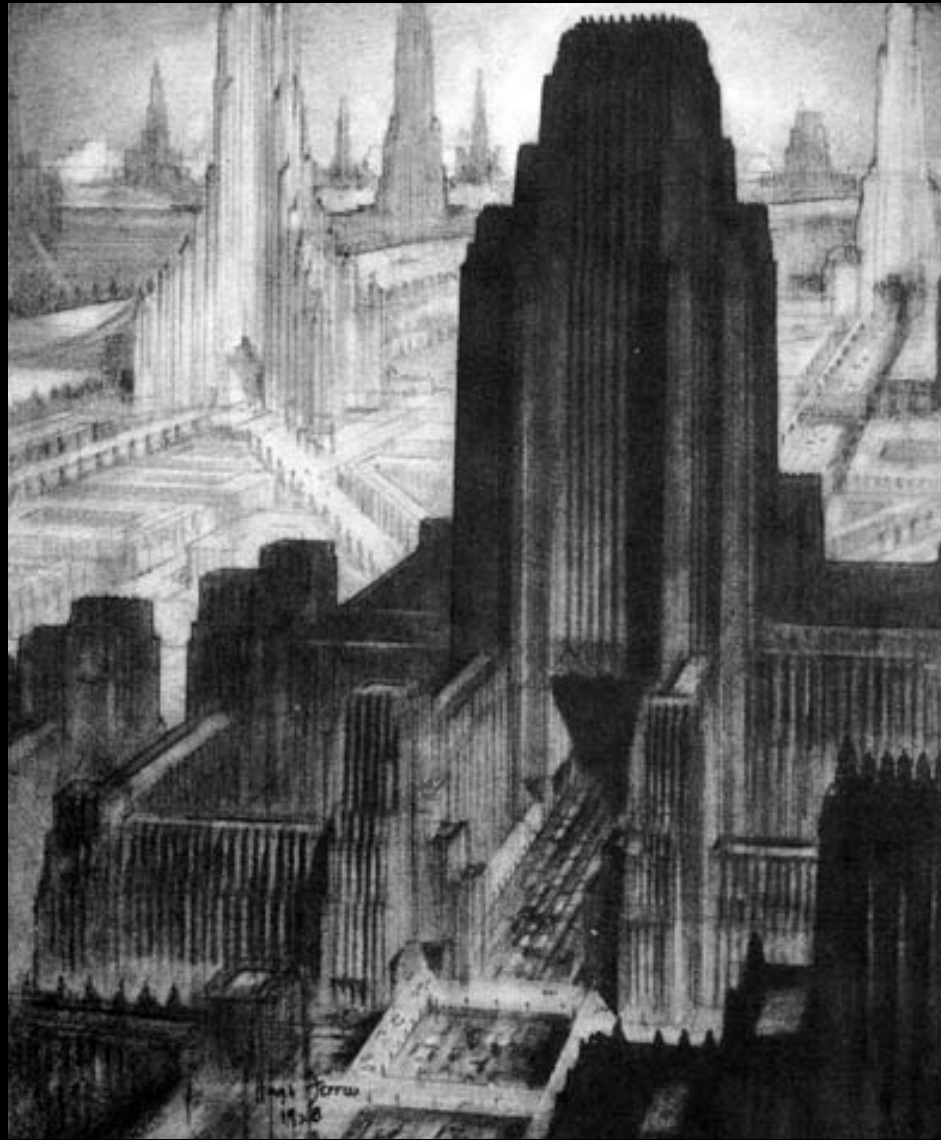

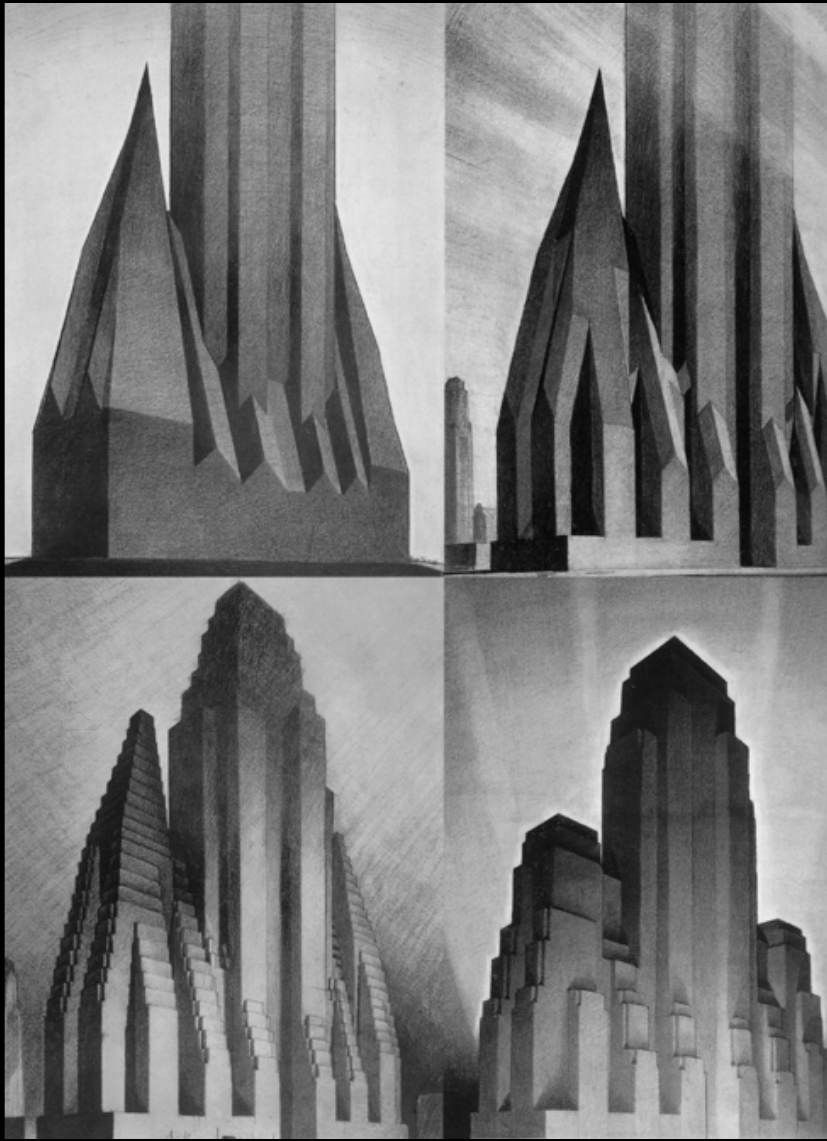

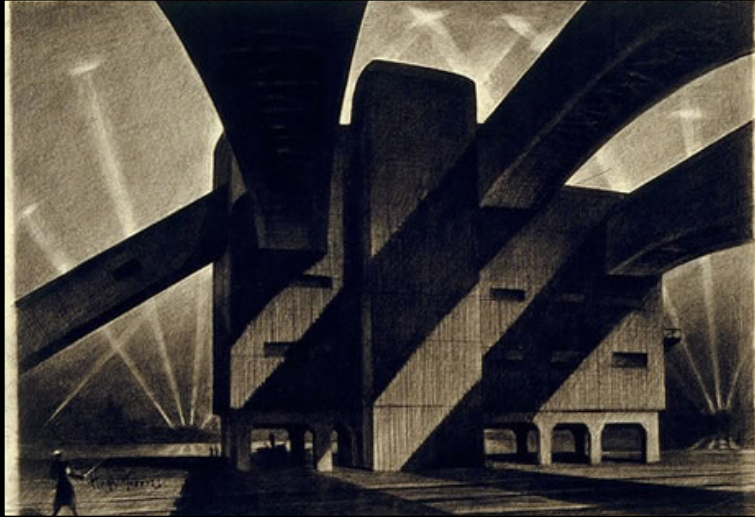
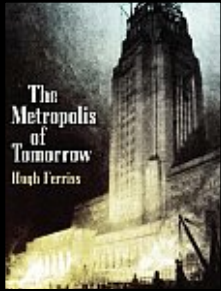

CRAIG ELLWOOD







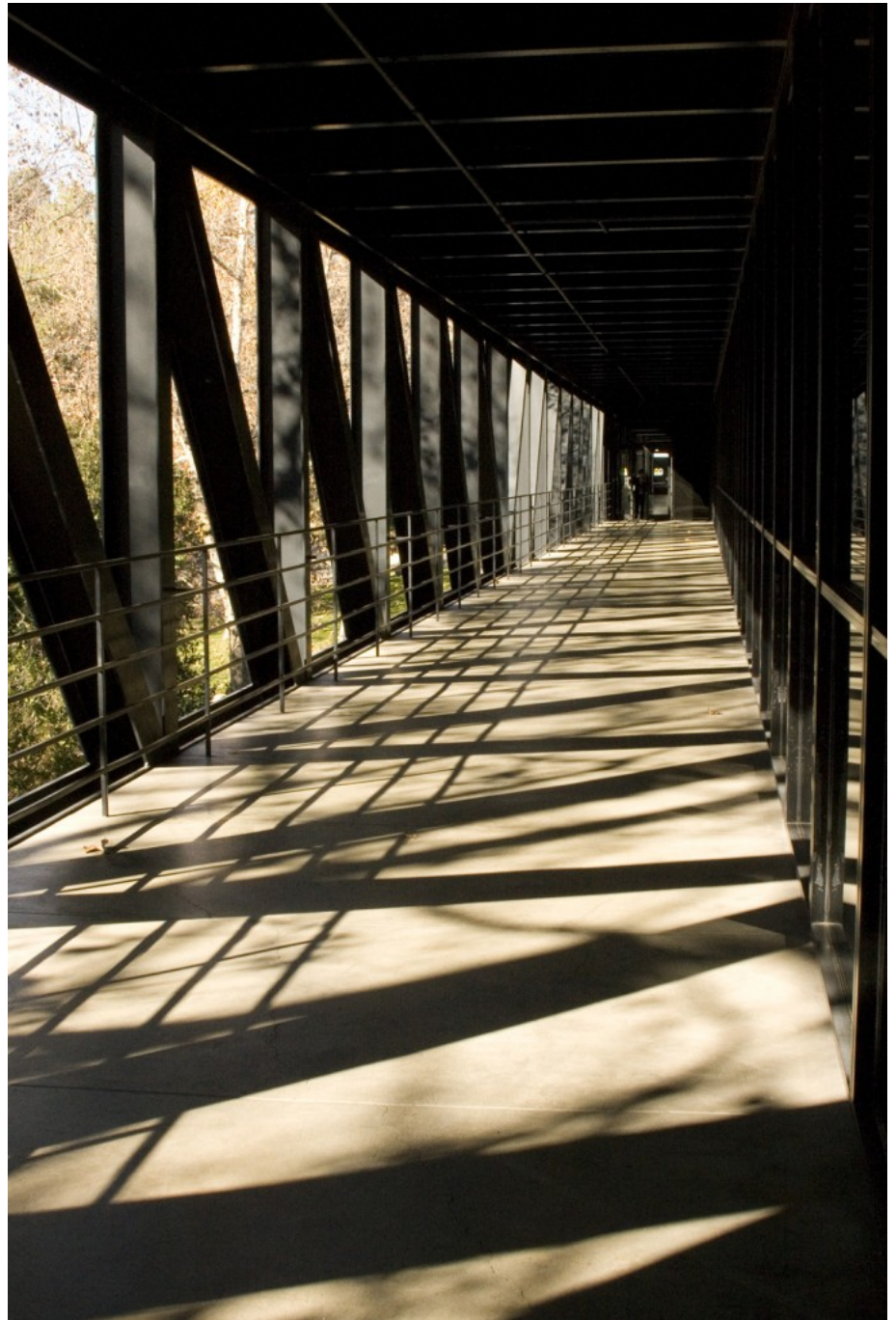

LIGHT













FOSTERS + ARUP

AQUEDUCT



MOTORWAY











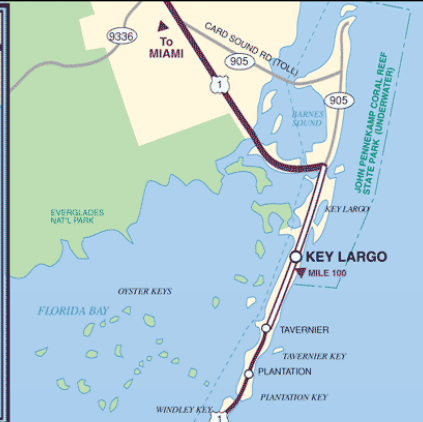
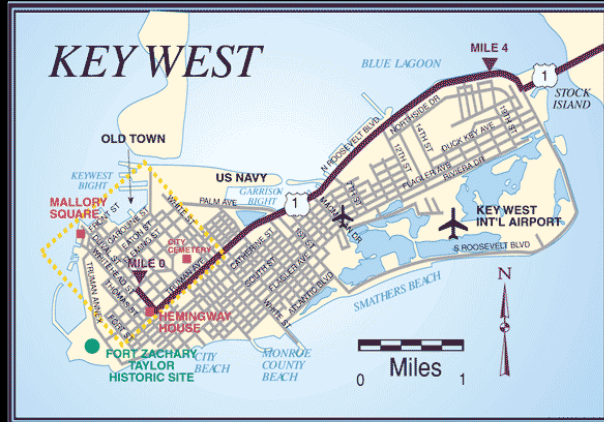

Miles
0 5 10 15
© TRIPmedia Group, Inc.





TALL









LE VIADUC DE MILLAU
YOUTUBE

ART. M. HEIZER









MALAYSIA





© malaysiahotelreview.com



© malaysiahotelreview.com

SPAIN

ALFA POLARIS



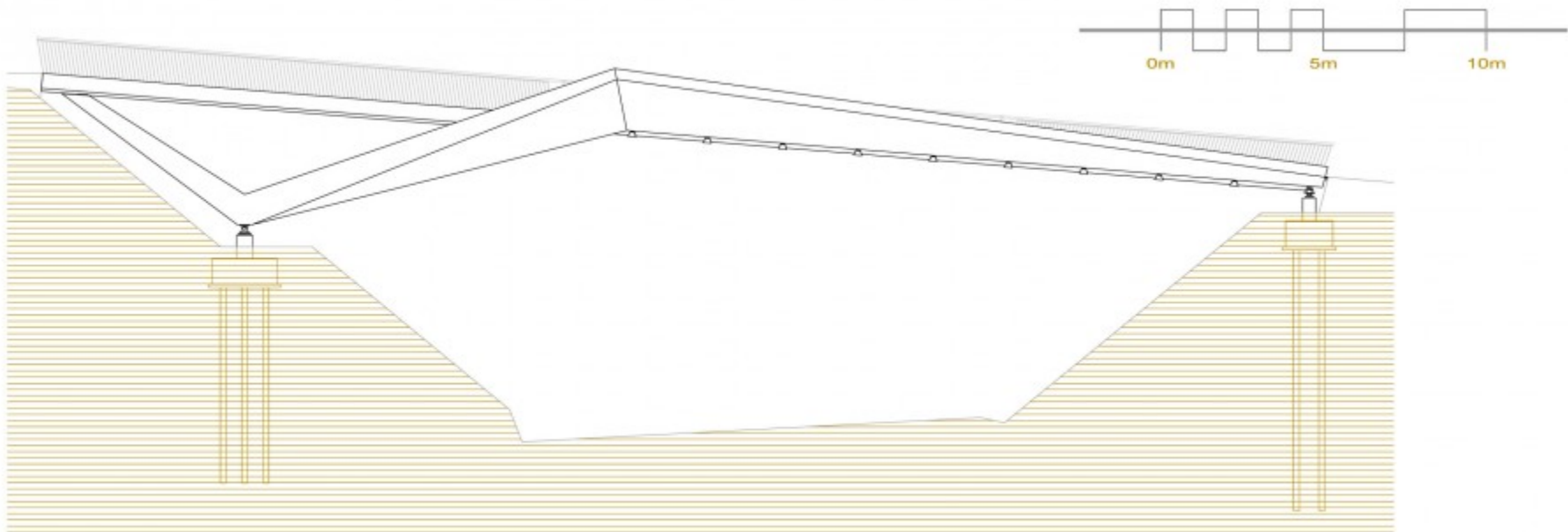

EAST ELEVATION (scale 1/150)







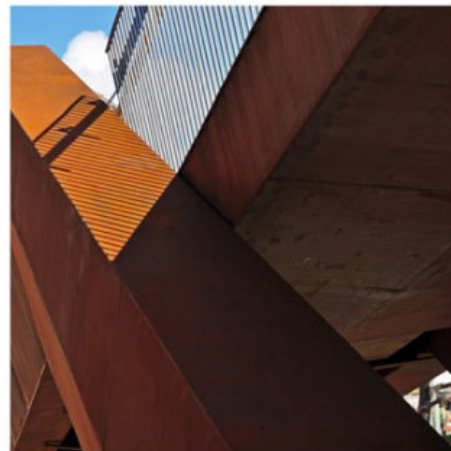
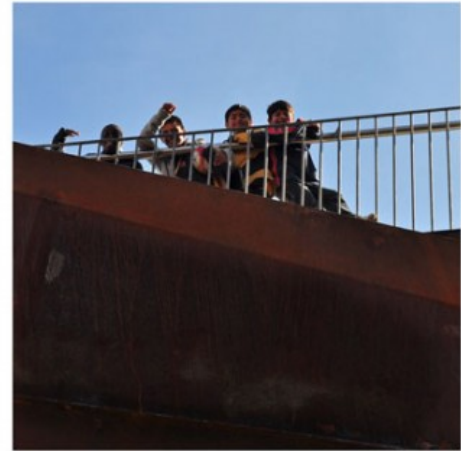
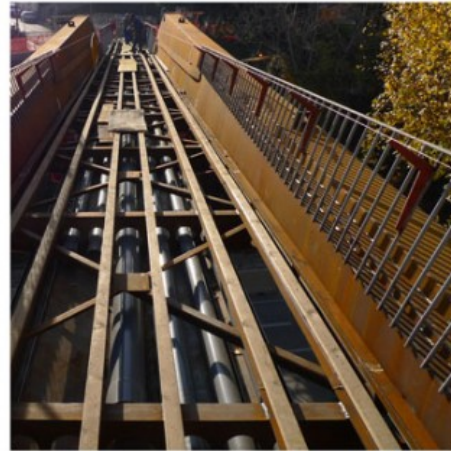
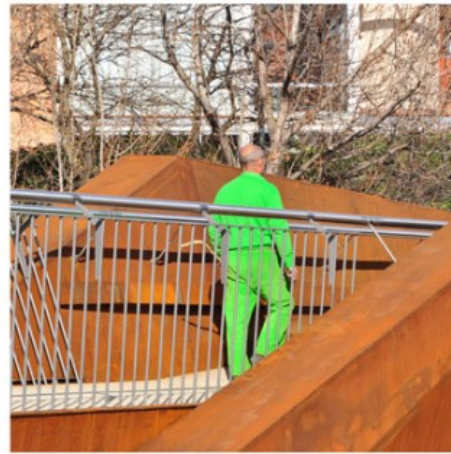

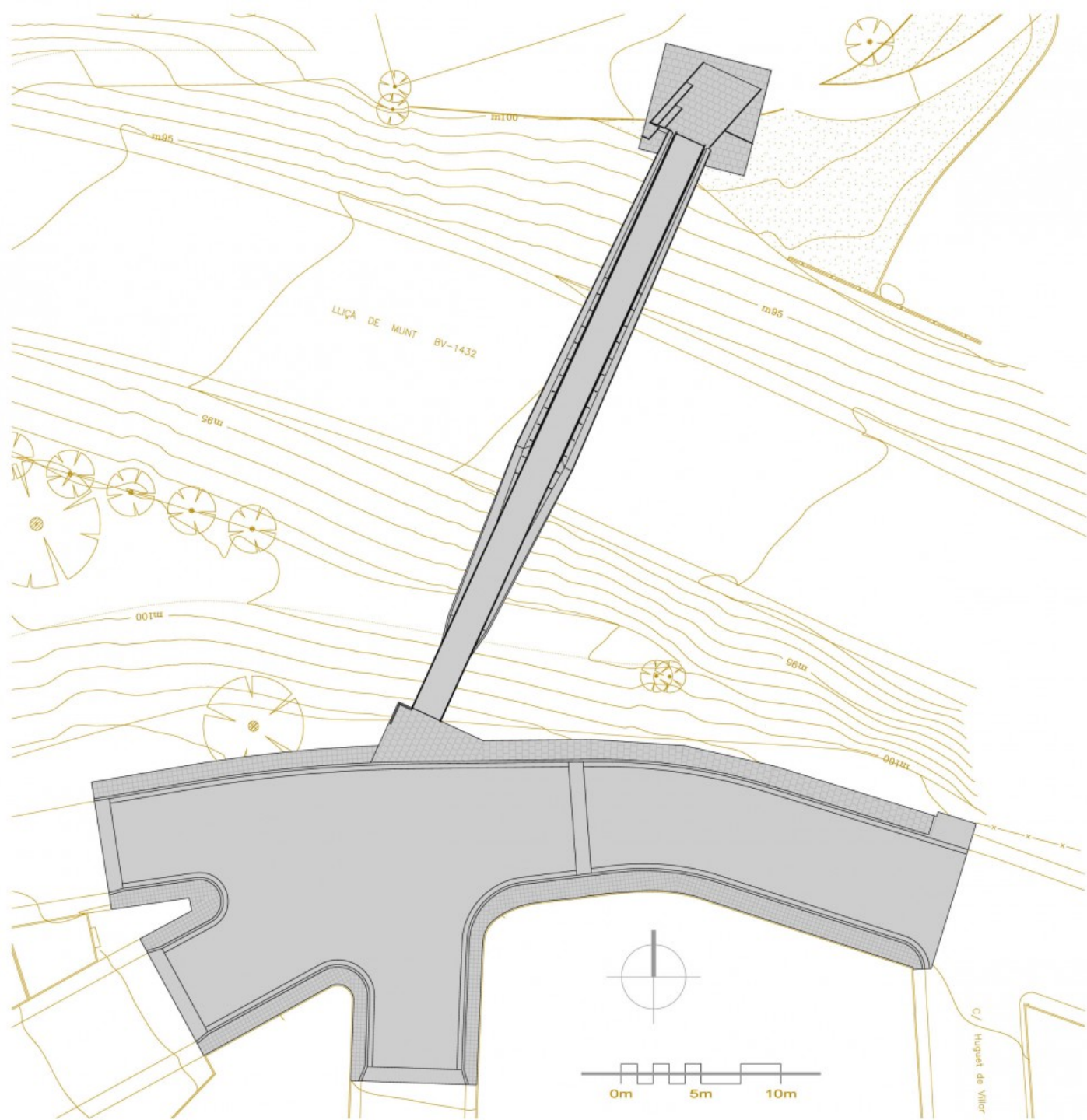

JA.STUDIO.INC





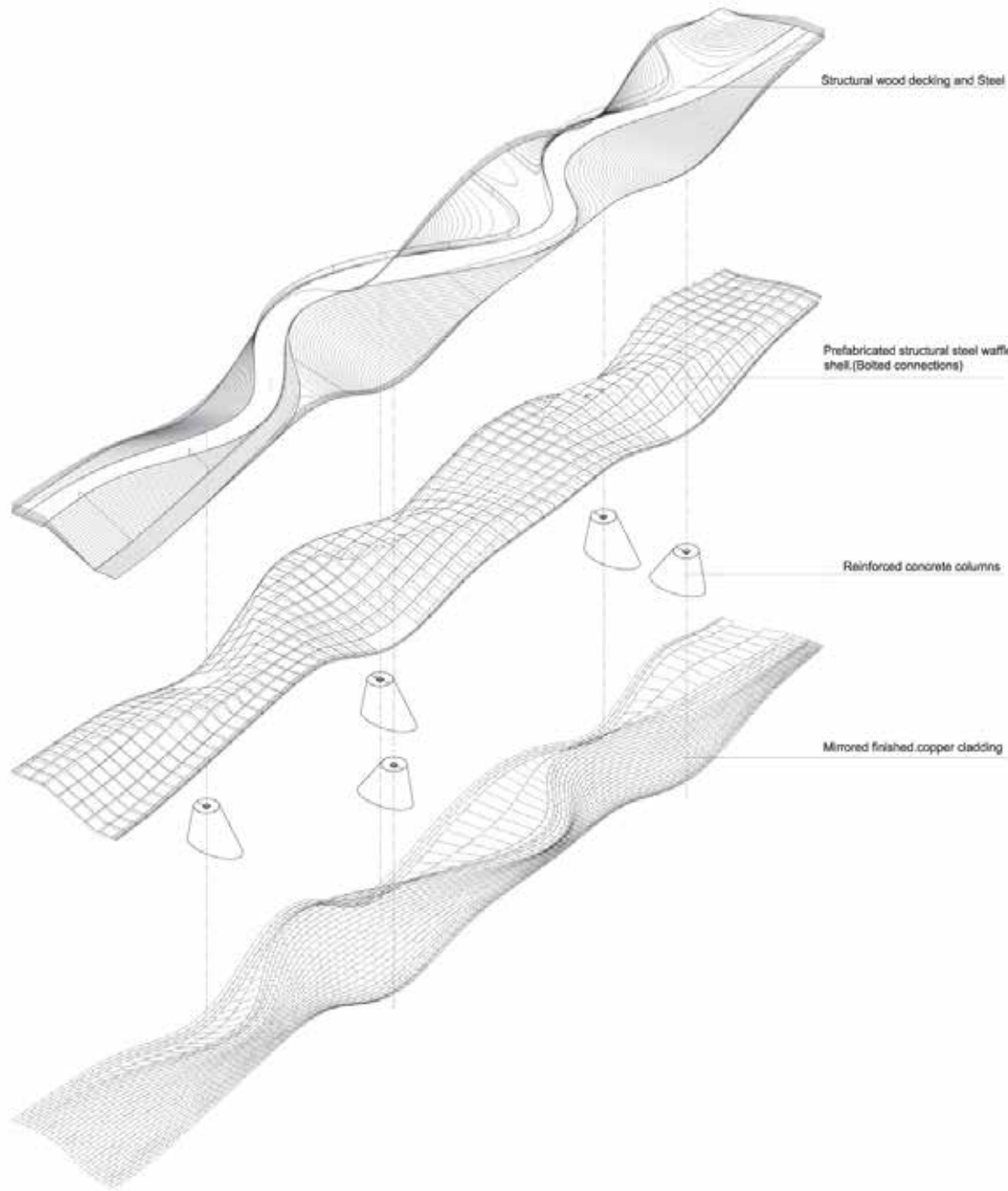

Structural wood decking and Steel

Prefabricated structural steel waffled shell (Bolted connections)

Reinforced concrete columns

Mirrored finished copper cladding

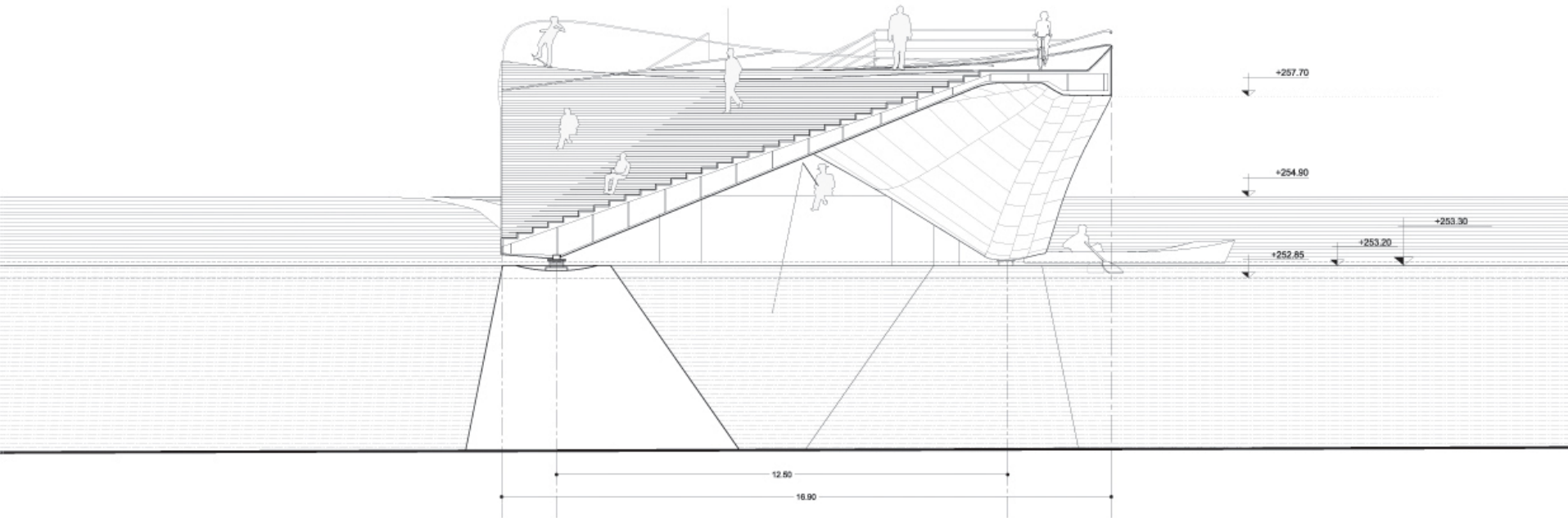





ZAHA HADID



ZARAGOZA





JURGEN MAYER H. ARCHITECTS

METROPOL PARASOL

TASK FOR TODAY'S STUDIO:

1. Divide the pages of your notebook in half. Draw a horizon line in the upper and lower halves. Use a single screen if using an iPhone or iPad or similar.
2. Draw a series of 6 one point perspectives exploring the relationship between three "H-Shaped" prisms in space. Think about the prisms themselves, and the spaces in between them, as concept designs for pathways in 3 dimensions. The proportions of the T-Shaped prisms should be different in each of your 6 drawings. Use carefully hatched lines to highlight one set of surfaces that exist in parallel planes.
3. For each of the 6 drawings above draw 2 more perspectives. The supplementary perspectives will show the H-Shaped prisms and their relationships in space from a different point of view (e.g. above you, at eye level, below you). Use carefully hatched lines to highlight one set of surfaces that exist in parallel planes.
4. Under each perspective drawing write a word that connects with your relationship to the prisms (e.g. above you, at eye level, below you) and also alludes to a relationship with power. The 18 words should be different.

Note: throughout the class students will be constructing examples of these perspectives using Sketchup and importing them into CryENGINE3.

QUESTIONS?